



# DELTA 2

230V 1p | 400V 3p



### **QR-CODES**

Download a QR-Code App on your smartphone and scan the QR-Code or use the link directly in your browser.

## **GENERAL**

---

- 4** Compressor Delta 2 Type 230V 1p & 400V 3p

## **TECHNICAL DATA**

---

- 6** Features
- 7** Device configuration
- 8** Technical datas
- 9** Dimensions in mm

## **OTHERS**

---

- 10** Metzger Technik
- 10** Custom-made production
- 11** Contact information

## Developed for the future.

Intelligent solutions through technical know-how, that is our successful concept of our **oil-free** compressor - series DELTA 2.

Versatile variants offers interesting combination possibilities. Whatever the task: different requirements can be individual and flexible fulfil.

Our Delta 2 type 230V and 400V production series is designed with a high efficient dry running reciprocating piston compressor, it offers decisive advantages such as **low wear** of the aggregate. In many cases this will avoid a replacement device, money and trouble.

DELTA 2  
230V | 400V

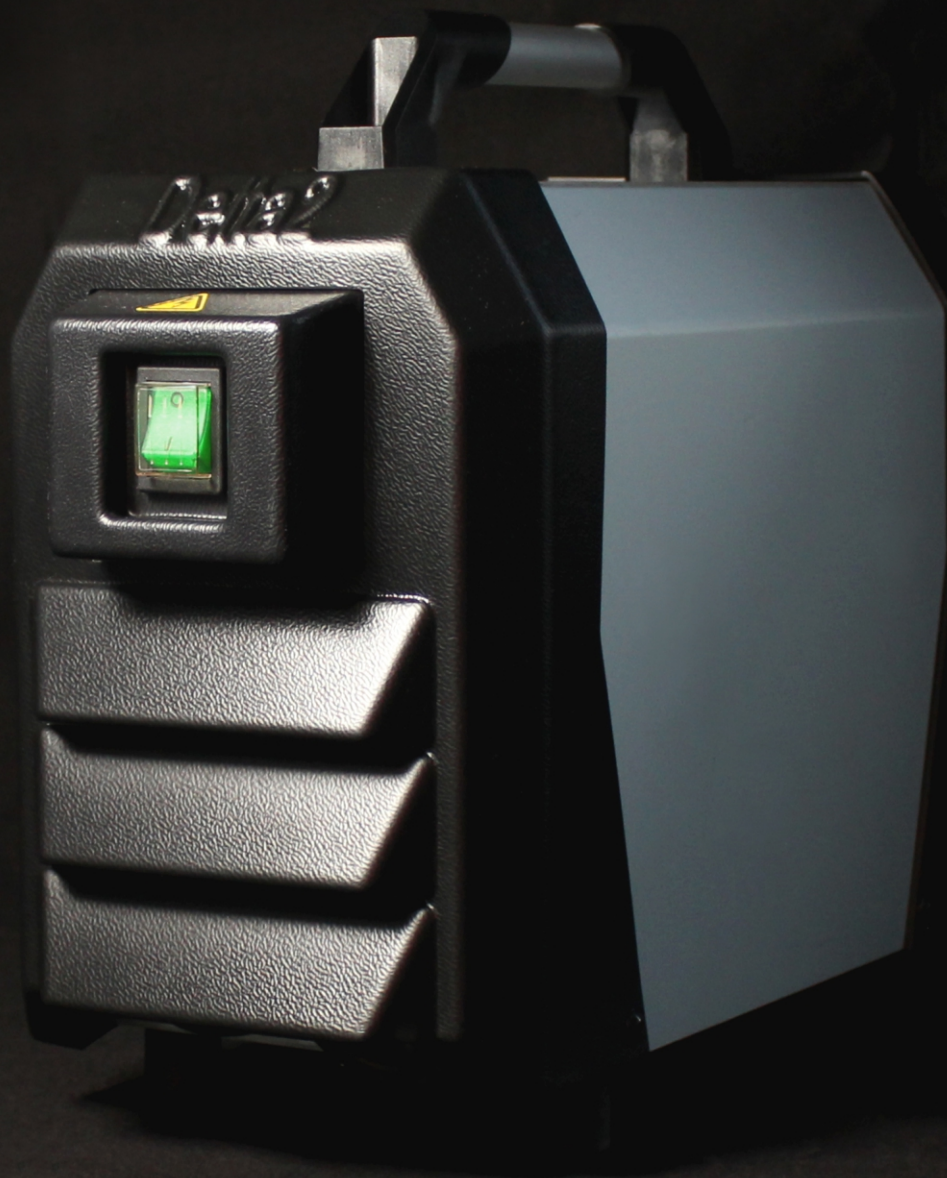



## The particular properties of the series DELTA2:

- robust case, easy cleaning by smooth surface
- high efficient compressor aggregate
- dry running
- oil-free
- Pressure up to **3,8 bar**
- Low power drain **0,52 KW** (230V), **0,55 KW** (400V)
- Either the suction- or the exhaust side is affected by dirt particle  
Protected by spin-on filter and two separate inlying intake filter
- Noise-damped **< 70 dba**
- Low weight
- With or without pressure switch available
- long idle time & favourable maintenance costs on linear wear
-  Made in Germany



# Device configuration



## Device model

**Delta 2 without pressure switch**  
Version 230V 1p and 400V 3p



**Delta 2 with pressure switch**  
Version 230V 1p and 400V 3p

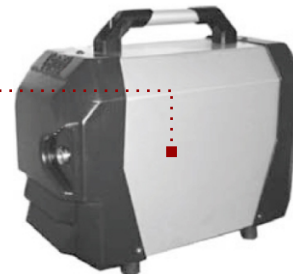

## Main switch



Main switch bei 230V 1p device  
Button green **ON** | Light out **OFF**

Main switch bei 400V 3p device  
Button black **ON** | Button red **OFF**

# Technical Data

|  | DELTA II 230V 1p +/- 5% | DELTA II 220/380 3p +/- 5% |
|--|-------------------------|----------------------------|
| Operating voltage  | 230 V                   | 220 / 380 V                |
| Frequency  | 50 / 60 Hz              | 50 / 60 Hz                 |
| Power rating   | 520 Watt                | 550 Watt                   |
| Nominal current ca.                                      | 3,3 A                   | 3,1 / 1,9 A                |
| Nominal speed  | 1.400 / 1.750 UPM       | 1.420 / 1.740 UPM          |
| Pressure ca.   | 3,8 bar                 | 3,8 bar                    |
| Opening pressure (PRV <sup>1</sup> ) ca.                 | 4,5 bar                 | 4,5 bar                    |
| Shut down pressure (Type DS <sup>2</sup> ) ca.           | 3,2 bar                 | 3,2 bar                    |
| Cut-in pressure (Type DS <sup>2</sup> ) ca.              | 2,4 bar                 | 2,4 bar                    |
| Continuous operation (Type without DS <sup>2</sup> ) ca. | 1,5 bar                 | 1,5 bar                    |
| Flow ca.   | > 180 / 210 l/min       | > 200 / 240 l/min          |
| Protection class   | IP 54                   | IP 44                      |
| Noise level  | < 70 db (A)             | < 70 dB (A)                |
| Ambient temperature                                      | -10 bis 40 °C           | -10 bis 40 °C              |
| Weight ca.   | 14,0 kg                 | 14,0 kg                    |

→ <sup>1</sup> PRV = Pressure safety relief valve  
<sup>2</sup> DS = Pressure cut-off switch

Technische Änderungen unter Vorbehalt

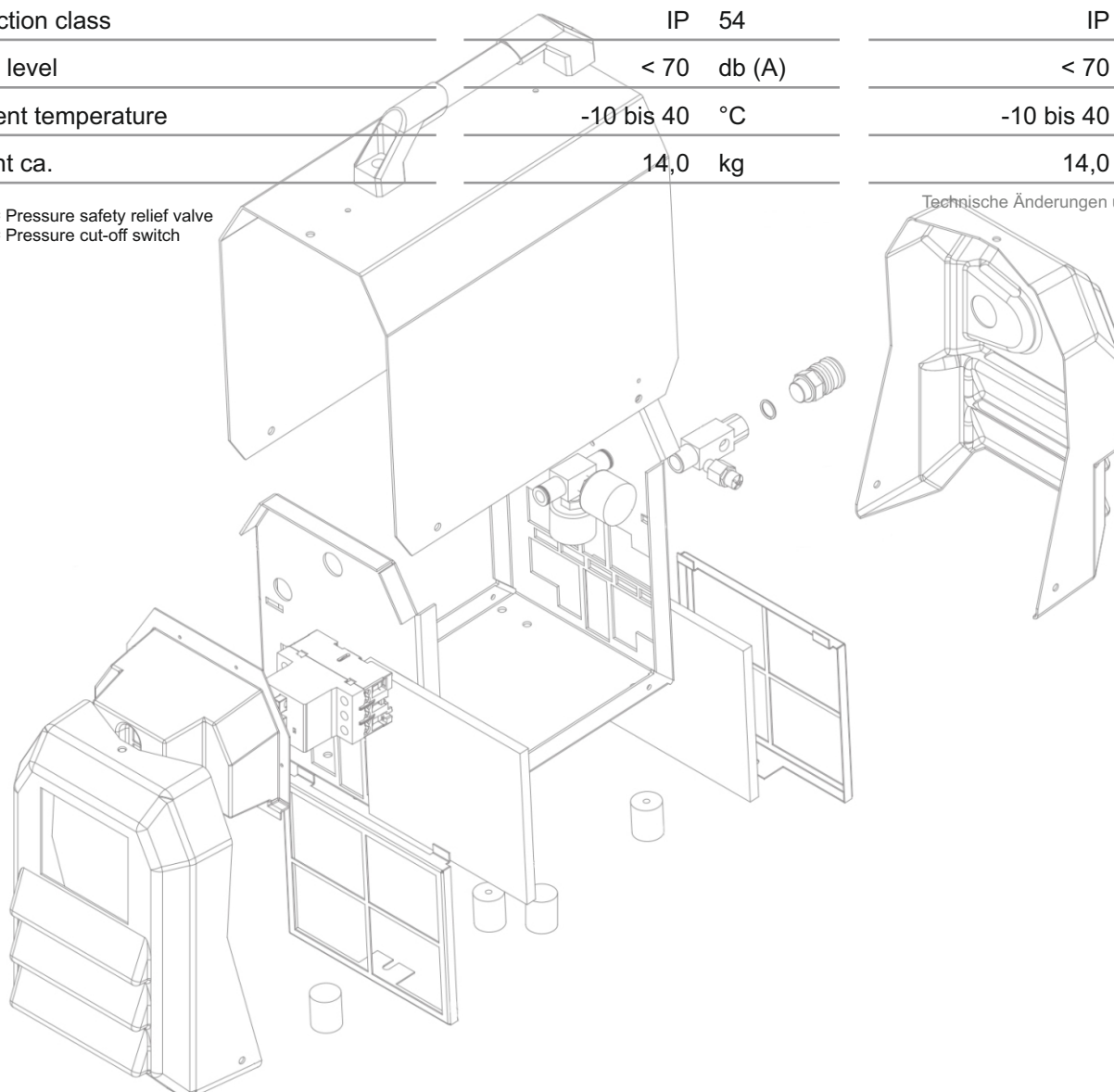

\* Reference to 230V execution: Optionally at max. 3,4 bar » 220V ± 5% are 60 cycles per second possible.



# Dimensions in mm

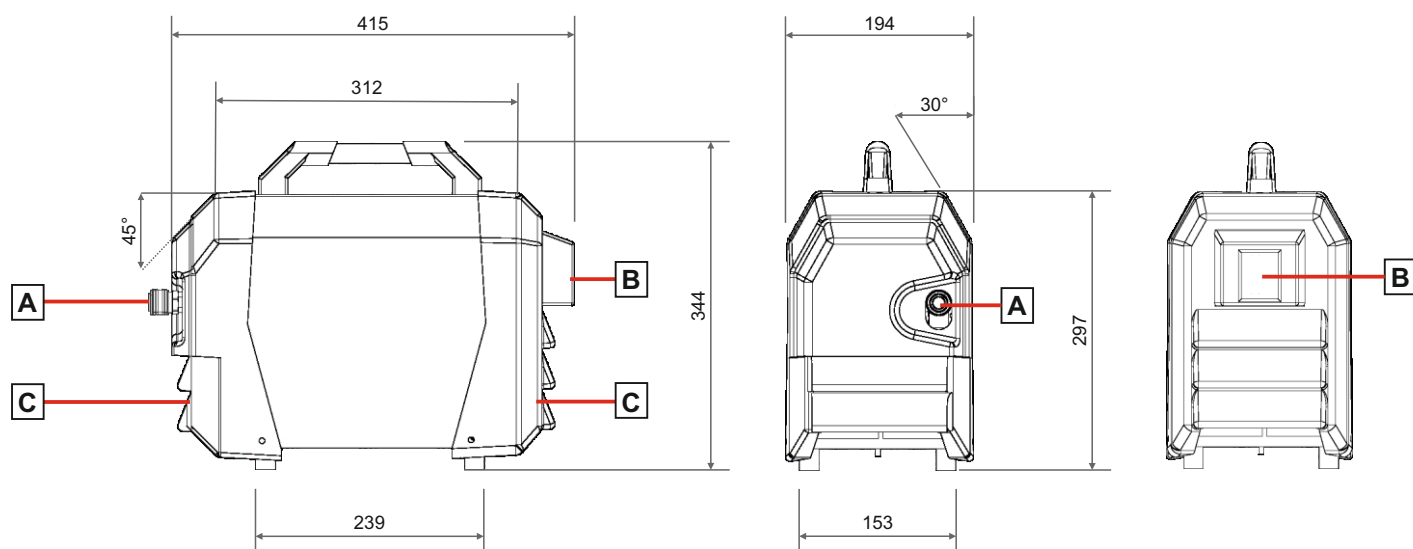

|                     |          |  |
|---------------------|----------|--|
| <b>Construction</b> | <b>A</b> | Pressure-Connection inside thread 1/8"   Quick connect outer thread 3/8" DN 7 (standard) |
|                     | <b>B</b> | Hauptschalter  |
|                     | <b>C</b> | Lüftung  |



We expressly indicate that the compressor must not operate without pressure cut-off switch. External pressure switches in machines must have the same switching cycles as the factory-set pressure switch from Metzger Technik (see table: Technical data) if no pressure switch is connected upstream, the compressor can be retrofitted without any problems

# Metzger Technik your competent partner

Reliable oil-free compressor and vacuum pumps.  
Minimal service, high profitability and environmentalism associated ideally.  
Qualified consulting, even with ambitious requirements.  
Using high-quality materials, thus minimal wear.  
Various accessories.

## Für custom-made device solutions

Based on our standard products we develop complete devices to your individual request.  
Whether limited dimensions for a compressor or a vacuum unit, special requirements on electrical design or ideas for an effective sound insulation are required - our specialists develop cost-effective solutions to your requirements.  
Profit from our longstanding experience for your optimal device.

**Contactus**

If you have any questions or need further information, do not hesitate to contact us:  
Browser: [www.metzger-technik.de/kontakt/](http://www.metzger-technik.de/kontakt/)

---

**Metzger Technik GmbH**

Compressor & Vacuum technology  
Bertha-Benz-Straße 1  
DE - 71665 Vaihingen an der Enz

Telephone        +49 7042 81518 0

E-Mail            info@metzger-technik.de  
Internet          www.metzger-technik.de

**Please visit our Online-Shop:**  
[www.metzger-technik-shop.de](http://www.metzger-technik-shop.de)





**Metzger Technik**  
Bertha-Benz-Straße 1  
71665 Vaihingen/Enz  
Germany

Browser: [www.metzger-technik.de](http://www.metzger-technik.de)